



MANUFACTURING

ADVANCED WIRE PRODUCTS





ITC Manufacturing is the premier manufacturer of wire mesh products for the material handling and storage products industries. The two ITC facilities produce a wide variety of wire products while specializing in decking, shelving and custom wire applications. ITC operates a 250,000-square-foot facility in Arizona and a 650,000-square-foot facility in Ohio. Using only top-quality materials, extensive testing procedures and a fully automated plant, ITC continues to be the leader in high-quality and competitive wire products.

A wide-angle photograph of the ITC Corporate Headquarters building in Phoenix, Arizona. The building is a modern, single-story structure with a light-colored facade and a prominent blue horizontal stripe. Large glass windows on the right side reflect the surrounding trees and sky. In the foreground, there are several large, dark green trees and a paved parking area. A sign in the window area reads "NOW HIRING Apply Inside".

ITC Corporate Headquarters Phoenix, Arizona

As a leading supplier to the material handling industry, ITC has coverage throughout the United States and services all of North America.

ITC's customer service and engineering teams are ready to assist you. From extreme capacity requirements to unique designs, the ITC team has the expertise to turn every challenge into a winning solution.

VISIT US AT ITCMFG.COM

MANUFACTURING & DISTRIBUTION

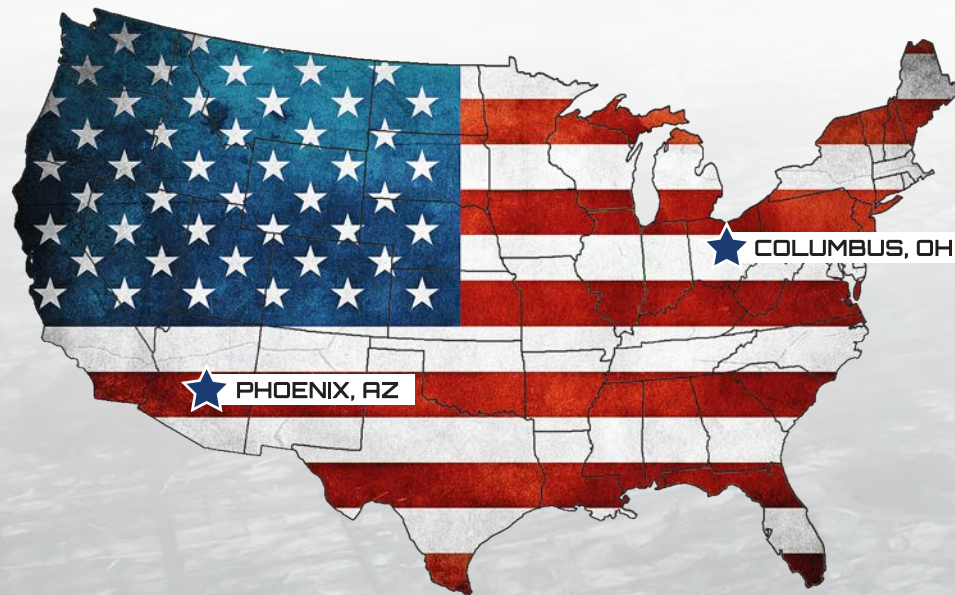

MANUFACTURING



1

Raw rod and sheet metal arrive directly from steel mills. ITC then draws and cuts the material into precise lengths & wire diameters to manufacture a wide variety of products.



2

High tech automated machines weld the wire with accuracy and consistency into flat mesh panels. Depending on the desired product, the panels are then mechanically formed and transported for any additional welding of support channels or wire.



3

The powder coating is then applied electrostatically for a brilliant result.



4

Quality control and testing are routinely incorporated throughout the manufacturing process prior to product being cleared to ship.

WIRE DECKING

DETERMINE YOUR NEEDS

THE ADVANTAGES

- ▶ Easy installation
- ▶ High visibility for inventory inspection
- ▶ Minimizes dirt build-up
- ▶ Improves air circulation
- ▶ Decreases insurance premiums
- ▶ Increases overhead sprinkler effectiveness
- ▶ Meets fire code standards
- ▶ Easy maintenance
- ▶ Promotes safety by limiting product fall-through

SUPPORT CHANNELS / CAPACITY

The steel support channels welded to the bottom of pallet rack decks supply the load-bearing capacity. Most decks use three support channels to get the standard 2,500 lbs. Step channels provide greater strength than flared channels. For some applications, such as food shortage, inverted channels are used.

GRID PATTERNS

The standard grid pattern is 2.5" x 4". However, for hand-stack applications, customers often need a tighter grid pattern for smaller objects. For these users, you may want to use a 1" X 4" or 1" X 6" grid pattern. These will have the top wires only an inch apart to handle even the smallest boxes. ITC's smallest grid capability is 1" x 2".

WATERFALLS

Although the standard for decking is the 1 ½" outside waterfall, variations are available for custom applications. For example, if your customer has a beam with a small face of 3" and wants to use this space for labels, barcodes, SKU numbers, etc., using a waterfall is better than not from a safety standpoint. Waterfalls may be upturned to create a backstop and prevent the hand-stacked product from interfering with the flue space.

ITC OFFERS

- ▶ ITC will engineer a wire deck specific to your customers' needs based on its capacity and application. This includes light duty for lower capacities and heavy duty for heavier or non-uniform loads.
- ▶ **Outdoor Decks:** Zinc-plated or hot-dip galvanized for great weather resistance
- ▶ **Anchored Decks:** Can be secured to the beam to stop beam separation and prevent deck movement

Support channels are integrated into decks, eliminating the need for pallet rack cross bars.

ITC produces various sizes, capacities and custom configurations to fit any rack specification.

STANDARD/STEP

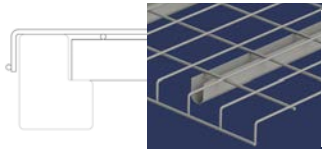

STRUCTURAL DECK

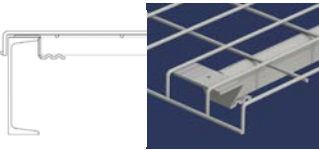

FLARED CHANNEL

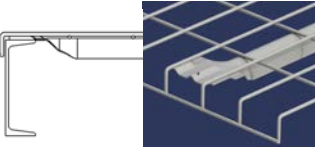

INVERTED

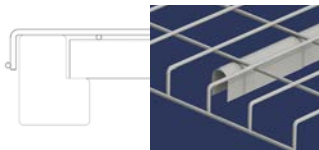

FLAT FLUSH

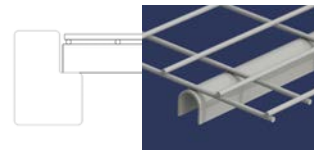

FLUSH WATERFALL

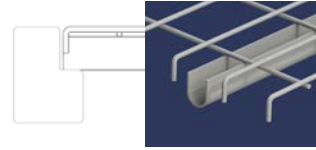

FLUSH DECKS

Flush Decks can be made with an inside waterfall or a flat flush edge where the end wire comes to the inside edge of the beam. For all flush decks, the deck depth measurement refers to the outside dimensions of the beams. For example, a 42" deep flush deck for a standard-style beam will only measure 38 1/4" deep. It should measure the same as the inside dimension of the beams, less than a quarter inch for installation. Flush decks are commonly used on lower levels for hand stacking and order-picking applications.

QUESTIONS
800.567.6592

All ITC products are manufactured in the U.S. - Assuring the highest quality standards available in the industry.



WIRE DECKING

HOW TO MEASURE

STOCK SIZES

24 x 46 · 3

36 x 46 · 3

42 x 46 · 3

42 x 46 · 3

42 x 52 · 3

42 x 58 · 3

44 x 46 · 3

48 x 46 · 3

48 x 52 · 3

48 x 58 · 4

ITC Part

C-ITC01-2446-G

C-ITC01-3646-G

C-ITC01-4246-G

C-ITC02-4246-G

C-ITC01-4252-G

C-ITC01-4258-G

C-ITC01-4446-G

C-ITC01-4846-G

C-ITC01-4852-G

C-ITC01-4858-G

Flared Decks

4246-BMEMM-3NB42U-G

Key measurements needed to properly fit deck to beam are:

- ▶ Outside dimension of beam
- ▶ Inside dimension of beam
- ▶ Top dimension of beam
- ▶ Step height of beam

42 x 46 · 3F

WIDTH

96" – beams: order – (2) 46" wide decks

108" – beams: order – (2) 52" wide decks

120" – beams: order – (2) 58" wide decks

144" – beams: order – (3) 46" wide decks

DEPTH

For standard waterfall-style decks, the deck's depth measurement refers to the distance from the outside of the back beam to the outside of the front beam. The decks are made slightly larger than this to allow for easy installation.

All ITC decks meet or exceed ANSI standards.

Custom sizes and grid patterns are available. Please contact your ITC sales representative for more information.

NOTE

For other size beam widths, use the following rule: For beams 120" or less, divide the width by two and subtract 2" to get deck width.

For beams over 120", divide the width by three and subtract 2" to get deck width.

This creates a small gap between decks and on each end which allows for easy installation. Sometimes you may get by with a smaller gap to use standard deck sizes and save costs. For example, with a 106" beam, two standard 52" decks could be used with a tighter fit, rather than following the formula and having two custom-sized 51" decks made.

MEASURING YOUR RACK

STANDARD/ STEP DECKS

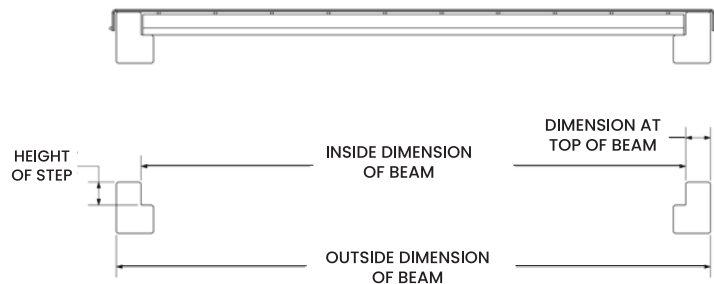

FLARED/ STRUCTURAL DECK

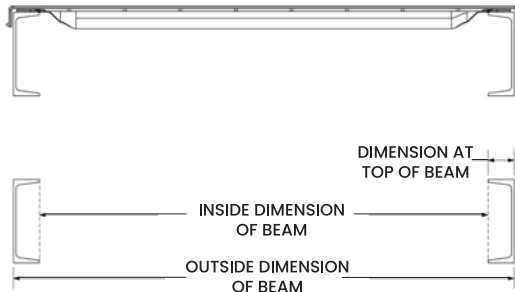

FLUSH DECKS

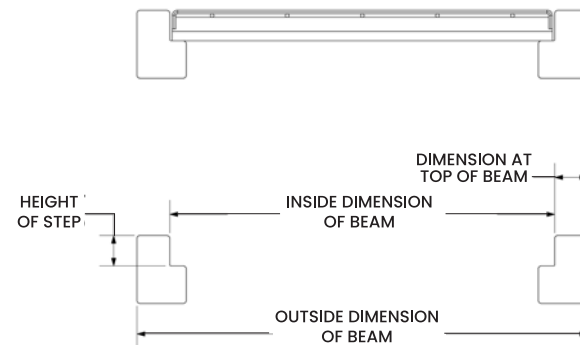

LIGHT DUTY DECKING

***ITC's light-duty decking is
a superior alternative
for particle board.***

All ITC products are
manufactured in the U.S.
– Assuring the highest
quality standards
available in the industry.



OPTION 1

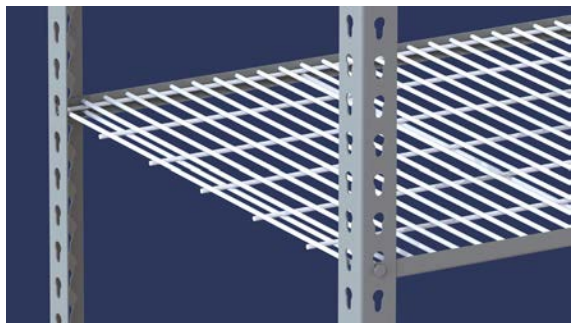

OPTION 2



ITC's light-duty decking is a superior replacement for particle board. With its 5-gauge wire construction and 2 X 4 grid pattern, it is stronger, safer and easily maintained.

Light-duty wire mesh decking from ITC can be used with all boltless, bulk and 'Z' beam-style racks. Customized sizing is available for non-standard racking. For capacity purposes, additional "support" wires are placed every 12 inches for extra support and rigidity in the application.

LIGHT DUTY STOCK SIZES

- ▶ LD-17Y47Y-200400E-5EG
- ▶ LD-23Y47Y-200400E-5EG
- ▶ LD-35Y47Y-200400E-5EG
- ▶ LD-47Y47Y-200400E-5EG

DIVIDERS & ACCESSORIES

ADVANTAGES

- ▶ Easy installation
- ▶ High visibility for inventory inspection
- ▶ Decreases insurance premiums
- ▶ Increases overhead sprinkler effectiveness
- ▶ Meets fire code standards
- ▶ Promotes safety

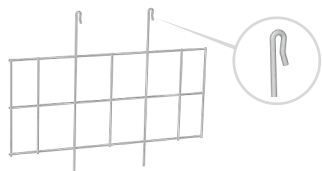

HANGING DIVIDER

These dividers hook onto the decking above and fit securely into the decking in the rack below. They are easily installed and can be customized to fit any application. ITC's new R-Hook design allows for a more secure fit that is unlikely to become dislodged while offering easy installation and beam-to-beam division.

HOW TO MEASURE

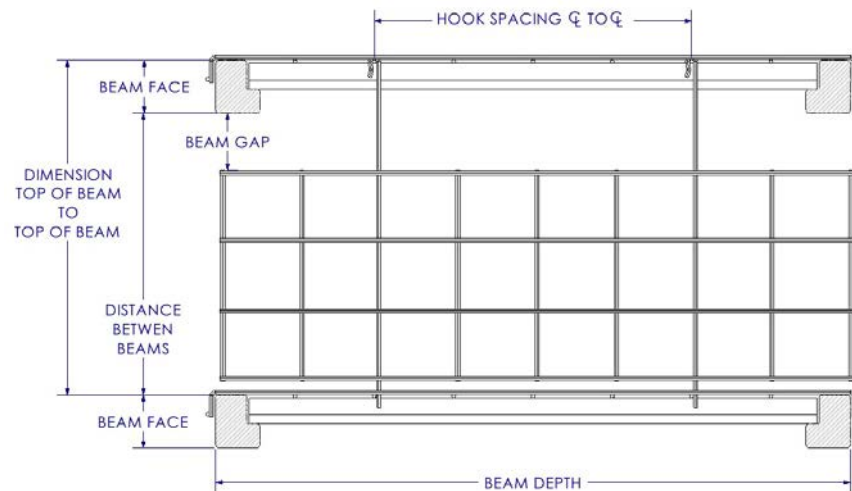

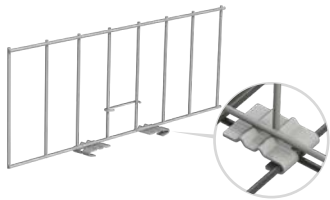

STANDING DIVIDER

The new design of ITC's standing divider offers an improved footplate design that allows the standing divider to sit more securely on the wire deck. This new footplate design in conjunction with ITC's center-mounted tension wire creates the most secure standing divider in the industry. Standing Dividers have dual attachment clips and tension wire to ensure rigidity and a tight fit.

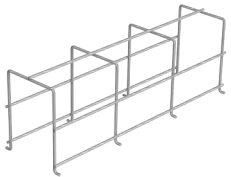

FLUE SPACER

Flue Spacers accommodate fire codes and can be used as a backstop and divider on the wire decks. *Fire codes may vary by city and state.

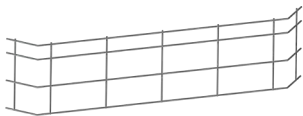

RACK UPRIGHT FLUE SPACER

Rack Upright Flue Spacers are built to order and designed to keep material out of the rack transverse flue space. ITC's tension mount design allows for easy installation while satisfying local fire codes.

PALLET SUPPORT

- ▶ Hat-shaped style/waterfall over the beam style
- ▶ Prevent pallet drop-through onto rack

Need an economical substitution for wire mesh decking?

ITC's hat-style pallet support has you protected by preventing pallets from accidentally dropping through between the beams.

Specifications:

- ▶ Flush fit design for 1 5/8" step beams
- ▶ Keeps beam face clear for labeling
- ▶ Cost-effective option to wire decking
- ▶ Tek screwing to the beams is recommended

HAT CHANNEL SUPPORT



FLARED CHANNEL SUPPORT



CUSTOM WIRE PRODUCTS

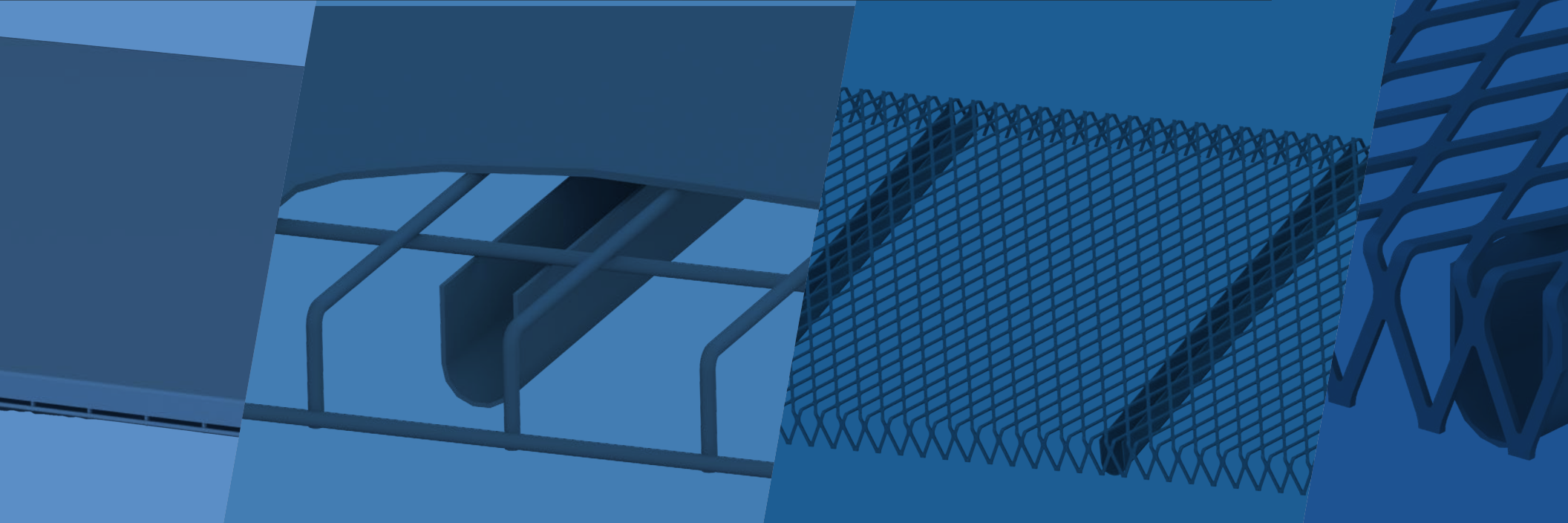

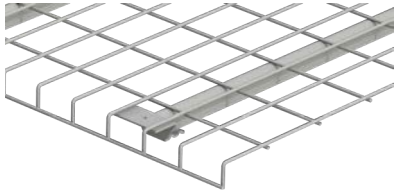

STRUCTURAL DECK

Industrial heavy-duty solutions to deck safety

ITC's structural deck offers a superior design to any other wire deck designed for structural racking systems. ITC's unique structural channel allows for the deck to hold more weight than a traditional flared channel. The ITC structural deck design will hold a uniform load independent of the support system and will also be R-Mark certified.

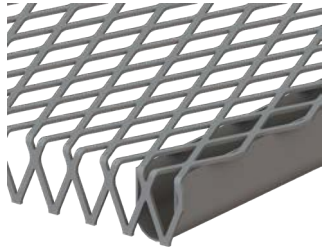

EXPANDED METAL FURNITURE DECK

ITC proudly offers our patented furniture deck. The furniture deck was conceived with the unique challenges of furniture storage in mind. Sitting flush inside the support beams, the furniture deck provides a smooth surface allowing all types of furniture and accessories to be easily stored without damage to legs and boxes. The small opening ensures legs will not get hung up or fall through while allowing an 80% open, exceeding all fire code requirements. The furniture deck is ideal for all types of specialty applications: archive and record storage, bulk clothing, carpet, food, retail displays and more.

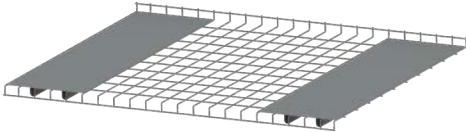

LANDING STRIP DECK

Designed for use with wire baskets and unique skids

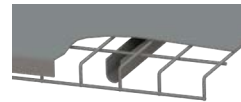

SHEET METAL DECK

Can be used for small product placement and/or fire baffle



PHOENIX, ARIZONA



COLUMBUS, OHIO

PHOENIX HQ

110 South 41st Ave.
Phoenix, AZ 85009

COLUMBUS

845 E Markison Ave.
Columbus, OH 43207



All ITC products are manufactured in the U.S. – Assuring the highest quality standards available in the industry.



TOLL FREE: 800.567.6592

PHONE: 602.415.1400

FAX: 602.415.1444

ITCMFG.com

ITC IS PROUDLY ASSOCIATED WITH THESE ORGANIZATIONS

